

IMPACT ACOUSTIC®

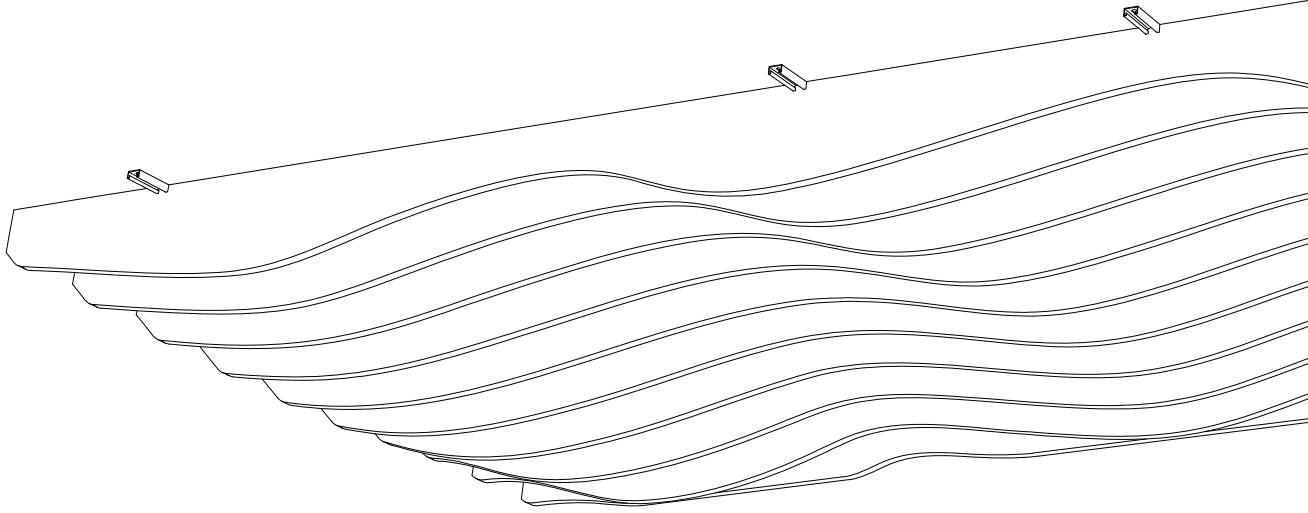

# Wave Morph Bespoke Ceiling Baffle

ASSEMBLY INSTRUCTIONS

# Wave Morph Bespoke

## Ceiling Baffle

The Baffle Bespoke Design system is customised and therefore may vary from the information in this document. The baffles can be endlessly attached to each other by using the dovetail joints. The prefabricated cut-outs also enable uncomplicated installation, as the baffles can simply be pressed into the rail.

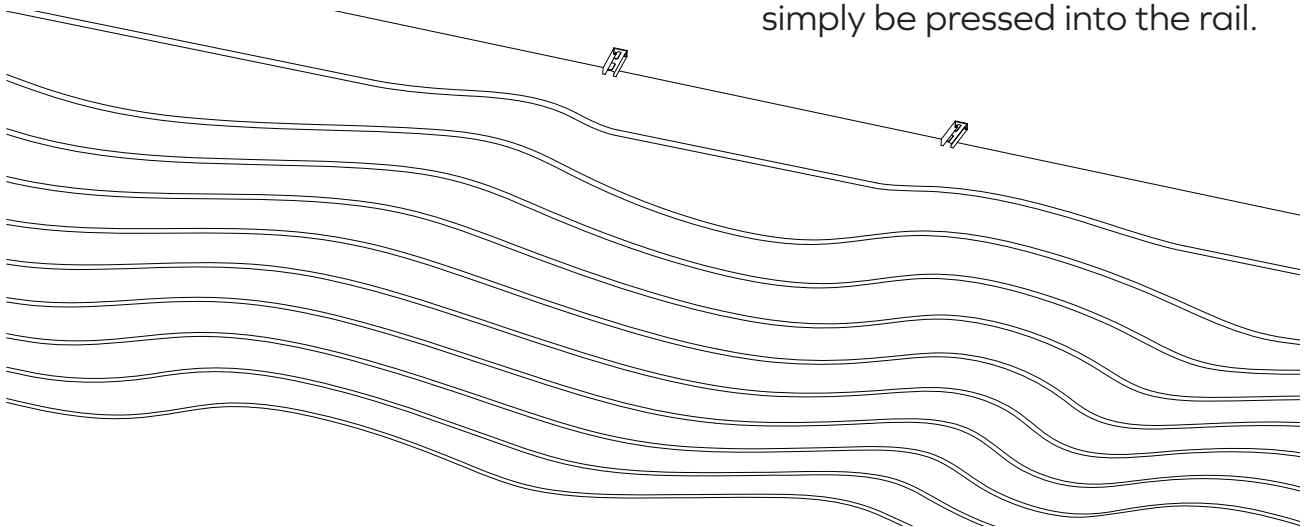

Hilti M-Schiene  
MM-C-16  
16 x 30 x 2000mm  
#418748

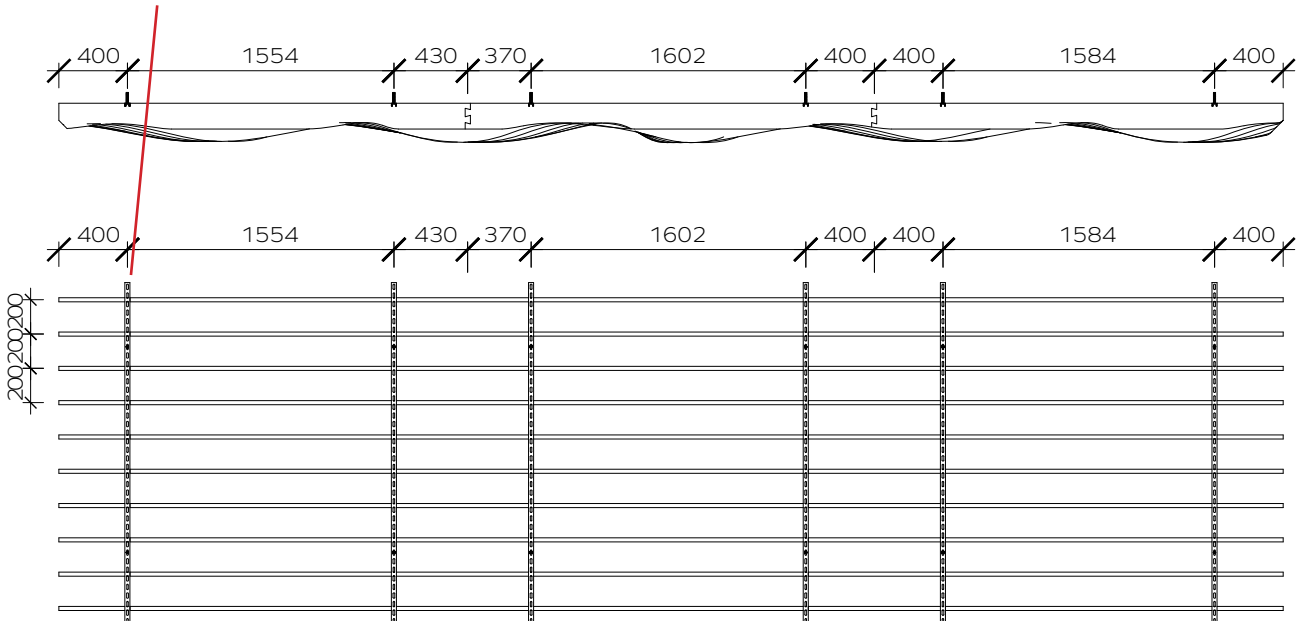

# 1

Mount the rails according to industry standards, e.g. using threaded rods.



# 2

Insert the baffle element into the rails. If applicable, the baffle elements are numbered, if this is the case, follow this order.

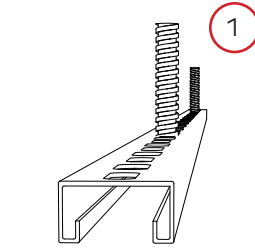

# 3

Insert another baffle element into the rails.

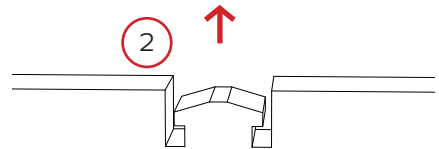

# 4

Connect the two baffle elements using the dovetail cuts. Continue with the remaining elements in the same manner.

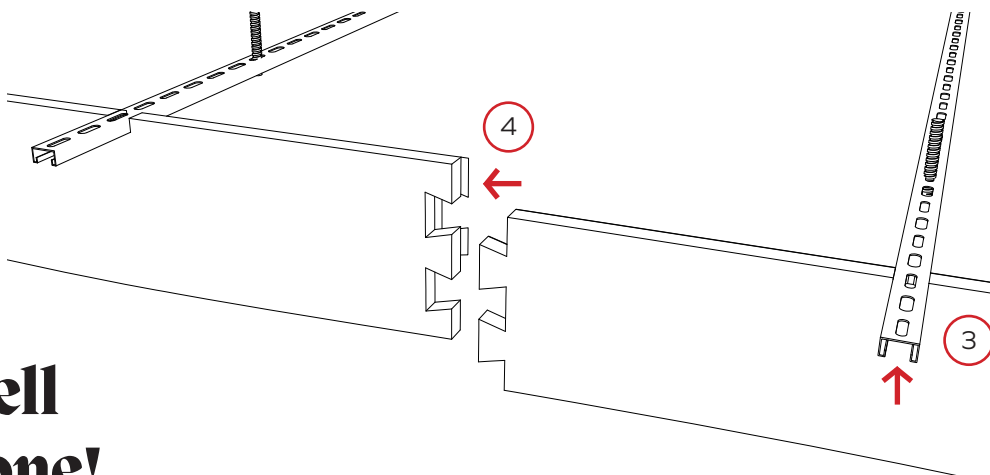
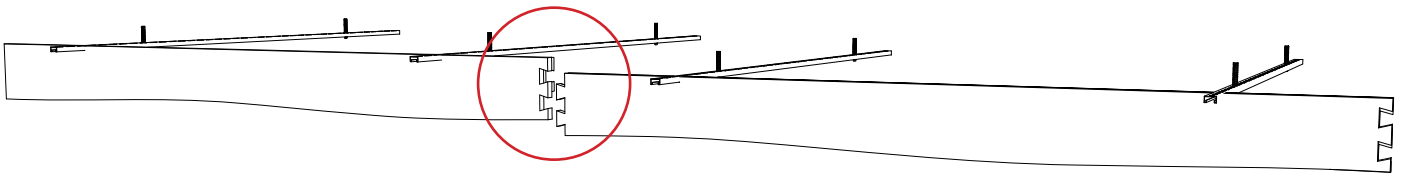

**Well done!**